

ALEXA 35 Xtreme

OPERATING MANUAL

August 2025 • 1.0 • English

D4510009176 • K11672



Disclaimer

Before using the product, be sure to read and understand all respective instructions.

The product is available for commercial customers only.

For product specification changes since this document was published, refer to the latest publications of ARRI data sheets or data books, etc., for the most up-to-date specifications.

Not all products and / or types are available in every country. Please check with an ARRI sales representative for availability and additional information.

The information given in this document is subject to change without notice.

While ARRI endeavors to enhance the quality, reliability and safety of their products, customers agree and acknowledge that the possibility of defects thereof cannot be eliminated entirely. To minimize risk of damage to property or injury (including death) to persons arising from defects in the products, customers must incorporate adequate safety measures in their work with the system and have to heed the stated canonic use.

ARRI or its subsidiaries expressly exclude any liability, warranty, demand or other obligation for any claim, representation, or cause, or action, or whatsoever, express or implied, whether in contract or tort, including negligence, or incorporated in terms and conditions, whether by statute, law or otherwise. In no event shall ARRI or its subsidiaries be liable for or have a remedy for recovery of any special, direct, indirect, incidental, or consequential damages, including, but not limited to lost profits, lost savings, lost revenues or economic loss of any kind or for any claim by third party, downtime, good will, damage to or replacement of equipment or property, any cost or recovering of any material or goods associated with the assembly or use of our products, or any other damages or injury of the persons and so on or under any other legal theory.

Neither ARRI nor its subsidiaries assume any liability for infringement of patents, copyrights or other intellectual property rights of third parties by or arising from the use of ARRI products or any other liability arising from the use of such products. No license, express, implied or otherwise, is granted under any patents, copyrights or other intellectual property right of ARRI or others.

In the case one or all of the foregoing clauses are not allowed by applicable law, the fullest extent permissible clauses by applicable law are validated.

ARRI or its subsidiaries do not assume any responsibility for incurred losses due to improper handling or configuration of the camera or other system components, due to sensor contamination, occurrence of dead or defective pixels, defective signal connections or incompatibilities with third party recording devices.

Document Revision History

Document ID: D45 10009176

Version	Release	Date	Note
1.0		July 2025	First release
1.01	K11672	August 2025	Certifications updated

Imprint

© 2025 Arnold & Richter Cine Technik GmbH & Co. Betriebs KG. All rights reserved.

The product contains proprietary information of Arnold & Richter Cine Technik GmbH & Co. Betriebs KG; it is provided under a license agreement containing restrictions on use and disclosure and protected by copyright law. Reverse engineering of the software is prohibited.

No part of this publication shall be used for distribution, reproduction, transmission, transcription, storage in a data retrieval system, or translated into any language in any form by any means without the prior written permission of Arnold & Richter Cine Technik GmbH & Co. Betriebs KG.

If you are downloading files from our web pages for your personal use, make sure to check for updated versions.

ARRI cannot take any liability whatsoever for downloaded files, as technical data are subject to change without notice.

Due to continued product development the information in this document may change without notice. The information and intellectual property contained herein is confidential between ARRI and the client and remains the exclusive property of ARRI. If you find any problems in the documentation, please report them to us in writing. ARRI does not warrant that this document is flawless.

ARRI, ALEXA 35, ARRIRAW and ARRICORE are trademarks or registered trademarks of Arnold & Richter Cine Technik GmbH & Co. Betriebs KG. All other brands or products mentioned are trademarks or registered trademarks of their respective holders and should be treated as such.



Apple ProRes 422 HQ, Apple ProRes 4444, Apple ProRes 4444 XQ, and the ProRes logo are trademarks or registered trademarks of Apple Computer, Inc., used under license therefrom.



JPEG XS licensed from Fraunhofer IIS
(<https://www.iis.fraunhofer.de/audio>).

This product uses licensed patents. See section "Licensed Patents [► 33]" for a complete list of licensed patents.

Initial Language

The initial language of this operating manual is English. Operating manuals in other languages are translations from English.

In the event of conflict between the respective languages (i.e. if any translation(s) of present document has/have been prepared for convenience or any other purpose), with regards to the meaning or interpretation of a word or an instruction etc., the contents and provisions of the English language version shall prevail.

Original version.

For Further Assistance

Arnold & Richter Cine Technik GmbH & Co. Betriebs KG

Herbert-Bayer-Str. 10

D-80807 Munich

Germany

E-mail: service@arri.de

Website: www.arri.com/en/technical-service

Table of Contents

1	About This Document	6
2	About This Product	8
2.1	Intended Use	8
2.2	Identification	8
2.3	Environmental Conditions	8
2.4	Technical Data	9
2.5	Dimensional Drawings	12
2.6	Scope of Delivery and Warranty	13
2.7	Certifications and Safety Standards	13
3	Safety Instructions	17
3.1	Structure of Safety and Warning Messages	17
3.2	Warning Symbols and Product Labels	18
3.3	General Safety Instructions	18
4	Product Overview	22
4.1	Camera Layout	22
5	Mounting and Assembly	25
5.1	Attachment of Accessories	25
5.2	Power Supply	26
5.3	Viewfinder Connection	28
6	Basic Operation	29
6.1	Menu Operation	29
6.2	Energize and De-energize	29
7	Cleaning and Repair	30
7.1	Cleaning Instructions	30
7.2	Repair	31
8	Transportation, Storage and Disposal	32
8.1	Transportation and Storage	32
8.2	Disposal	32
9	Licensed Patents	33
10	ARRI Service Contacts	34

1 About This Document

This operating manual is for everyone who uses the device. It gives directions on how to operate the device safe and as intended. Read the operating manual before you use the device for the first time to make sure that the use is safe and correct.

This operating manual is an important part of the device. It shall be easily accessible and near to the device so that users can use it anytime as a reference.

The user manual contains more detailed information about the features and functionalities of the device. Please visit the website www.arri.com to download the user manual.

Keep the operating manual, the user manual and all other operating and assembly instructions for the device in a safe area for future reference and possible subsequent owners.

For useful information in addition to these manuals please have a look at the [ARRI learn & help](#) section on the [ARRI website](#).

The ARRI Academy courses provide unrivalled insights into the full possibilities of working with ARRI camera systems, lenses, lighting systems and accessories.

Our advanced service training courses are designed to transfer detailed knowledge about how to service and repair all types of ARRI products and give you permanent access to detailed service instructions, special tools and service parts. To learn more, please visit [ARRI academy](#) or contact academy@arri.de.

For more details about the product, please refer to the ARRI website at:

[ALEXA 35 product page](#)



The ARRI documentation portal provides important documents on the product for free download.

Please enter the following searchkeys in the search bar to retrieve the documents for the product:

ALEXA 35 , K1.0039373

[ARRI documentation portal](#)



How to Use This Operating Manual

All directions are given from a camera operator's point of view. For example, camera right side refers to the right side of the camera when standing behind the camera and operating it in a normal fashion.

Connectors are written in all capital letters, for example "AUDIO connector".

Buttons are written in italic typeface capital letters, for example "*PLAY* button".

Menu paths are written in italic typeface, with menu and home in capital letters, for example "*MENU > Recording > Sensor Mode*".

"EVF" refers to the OLED eyepiece of the MVF-2 viewfinder.

"Monitor" refers to the flip-out monitor of the MVF-2 viewfinder.

"VF" refers to the viewfinder connectors VF 1 and VF 2. When settings refer to VF, they affect the EVF and the flip-out monitor.

"Monitoring outputs" refers to EVF, flip-out monitor, SDI 1, and SDI 2.

"Status Info" refers collectively to the Status Info of EVF, SDI 1 and SDI 2.

2 About This Product

2.1 Intended Use

The ARRI ALEXA 35 is a 35mm digital camera. Use it solely and exclusively for recording images at various resolutions for a variety of distribution formats:

- Open Gate 4.6K, 16:9 4.6K, 4K, UHD, 2K and HD recording resolutions
- ARRIRAW, ARRICORE and Apple ProRes Codecs
- LogC4 or ARRIRAW encoding
- Codex Compact Drive recording
- Up to 660 fps



NOTICE

All versions of the ALEXA 35 and its accessories are intended exclusively for professional use. It shall be used only by approved persons. The ALEXA 35 its accessories shall not be used by not approved users and without training.

Read and understand the user manual before use.

Use the ALEXA 35 and its accessories only as described in this document. Always follow the safety instructions and system requirements for all equipment involved. ARRI assumes no liability for damage or modification that is caused by incorrect use. You are not allowed to modify the ALEXA 35 and its accessories other than described in this manual.

2.2 Identification



The camera serial number is printed on the product label on the left side of the camera adjacent to the media bay door.

The serial number consists of the last 5 digits of the product number K1.0053455-XXXXX.(here: 12345).

2.3 Environmental Conditions

The ALEXA 35 should only be used and stored under specified environmental conditions.

Check the following conditions before commissioning and operation:

Permitted Operating Temperature, general	-20° C to +45° C / -4° F to +113° F
Permitted Operating Temperature, when using:	
• more than 120 fps (all sensor modes)	-20° C to +40° C / -4° F to +104° F
• 90 fps or more in 4.6K 3:2 OG or 3.3K 6:5	-20° C to +40° C / -4° F to +104° F
Permitted Storage Temperature	-30° C to +70° C / -22° F to +158° F
Permitted Humidity	0-95% RH Noncondensing

2.4 Technical Data

Sensor Type	Super 35 format ARRI ALEV 4 CMOS sensor with Bayer pattern color filter array
Sensor Photosites and Size	4608 x 3164 27.99 x 19.22 mm / 1.102 x 0.757" Ø 33.96 mm / 1.337"
Sensor Frame Rates	0.75 - 660 fps
Project Frame Rates	23.976, 24, 25, 29.97, 30, 48, 50, 59.94, 60 fps
Weight	2.9 kg / 6.4 lbs (camera body with three antennas and LPL Mount (LBUS))
Photosite Pitch	6.075 µm

Exposure Index	Adjustable from EI 160 - 6400 in 1/3 stops
Dynamic Range	17 stops
Shutter	Electronic shutter, 1.0°- 356° or 1s - 1/8000s
Recording Codecs	MXF/ARRIRAW MXF/ARRICORE MXF/Apple ProRes 4444 XQ MXF/Apple ProRes 4444 MXF/Apple ProRes 422 HQ
Recording Media	Codex Compact Drive 1TB (CA08-1024), Codex Compact Drive 2TB (CB16-2048)
Recording Modes	Standard real-time recording, Pre-recording
Viewfinder Type	Multi Viewfinder MVF-2 with OLED viewfinder display (1920 x 1080) and 4" LCD flip-out monitor (800 x 480)
Viewfinder Diopter	Adjustable from -5 to +5 diopters
Color Output	Rec 709, Rec 2020, Rec 2100 PQ, Rec 2100 HLG, LogC4
Look Control	ARRI Textures Custom color look (through ARRI Look File ALF4 or ARRI Look Library)
White Balance	Manual and auto white balance, adjustable from 2000K to 11000K. Color correction adjustable from -16 to +16 CC (1 CC corresponds to 035 Kodak CC values or 1/8 Rosco values)
Filters	Four position built-in motorized ND filter: Clear, 0.6, 1.2, 1.8. Fixed optical low pass, UV, IR filter
Lense Squeeze Factors	1.00, 1.25, 1.30, 1.33, 1.50, 1.65, 1.80, 1.85, 2.00
Exposure and Focus Tools	False Color, Zoom, Aperture and Color Peaking
Audio Recording	4 channel linear PCM (24 bit, 48 kHz)
Image Outputs	2x VF custom CoaXPress connectors for MVF-2 viewfinder 2x 12G SDI (BNC) 422 1.5G HD, 422 3G HD, 444 3G HD, 422 6G UHD, 422 12G UHD, 444 12G UHD

Interfaces	1x LBUS (LEMO 4pin) for lens motors, daisy chainable 1x SERIAL (LEMO 4pin) for distance measuring accessories 1x TC (LEMO 5pin) for timecode In/Out 1x ETH (LEMO 10pin) for remote control and service 1x SYNC IN (BNC) for Genlock synchronization 1x RET IN (BNC, switchable on SDI 2) 1x USB-C for user setups, look files etc 1x Rear Interface (18-pin Pogo) 1x Top Interface (5-pin Pogo)
Audio Inputs	1x AUDIO (LEMO 6pin) for balanced stereo line in (line input max. level +24 dBu correlating to 0 dBFS) Two built-in microphones for scratch audio With Audio Extension Module AEM-1: additional 3x TA3 connectors (MIC/Line, +48 V, AES)
Audio Outputs	1x AUDIO (LEMO 6pin) for balanced stereo line in (line input max. level +24 dBu correlating to 0 dBFS)
Power Inputs	1x PWR (LEMO 8-pin) 1x BAT (camera rear interface / battery adapter) 20.5 V - 33.6 V DC
Power Outputs	1x RS (Fischer 3pin) for 24 V accessory power out, start/stop and shutter pulse 1x 12 V (LEMO 2pin) for 12 V accessory power out 1x LBUS (LEMO 4pin) for lens motors & 24 V power out, daisy-chainable 1x AUDIO (LEMO 6pin) for balanced stereo line in and 12 V accessory power out 1x ETH (LEMO 10pin) for remote control, service and 24 V accessory power out With Power Distribution Module PDM-1: additionally 4x 24 V, 2x 12 V and 1x D-Tap
Remote Control Options	Camera Companion App ARRI Electronic Control System (ECS) Web-based remote control from phones, tablets and laptops via WiFi & Ethernet Camera Access Protocol (CAP) via WiFi & Ethernet GPIO interface for integration with custom control interfaces
Wireless Interfaces	Built-in WiFi module (IEEE 802.11b/g) Built-in White Radio for ARRI ECS lens and camera remote control
Lens Mounts & Adapters	ARRI LPL Mount (LBUS) ARRI PL-to-LPL Adapter ARRI PL Mount (LBUS) ARRI PL Mount (Hirose) ARRI EF Mount (LBUS) Leitz M Mount for ARRI
Flange Focal Depth	LPL Mount: 44 mm , PL mount: 52 mm
Power Consumption	~ 81 W (Camera body and MVF-2 typical, max. 310 W with all accessories)

Dimensions (HxWxL)	147 x 152.5 x 203 mm / 5.8 x 6.0 x 8.0" (camera body with LPL lens mount)
Permitted Operating Temperature	General: -20° C to +45° C / -4° F to +113° F When using more than 120 fps (all sensor modes) or 90 fps or more in 4.6K 3:2 OG or 3.3K 6:5: -20° C to +40° C / -4° F to +104° F
Permitted Storage Temperature	-30° C to +70° C / -22° F to +158° F
IP Rating	IP 51
Sound Level	< 20 dB(A) at 30fps, recording 4K 16:9 - UHD, Apple ProRes 4444 XQ, ≤ +30° C ambient temperature
Licenses	Highspeed, ARRIRAW, OpenGate / Anamorphic, Look, Pre-recording, Premium, Live Cine Plus

Sensor Modes	Active Image Area (Dimensions)	Image Circle (Ø)	Recording Resolution (Pixel)	Maximum Frame Rate (Standard / with Sensor Overdrive)		
				Codec	1 TB	2 TB
4.6K 3:2 Open Gate	28.0 x 19.2 mm 1.102 x 0.756"	33.9 mm 1.337"	4.6K (4608 x 3164)	ARRICORE ARRIRAW ProRes 422 HQ ProRes 4444 ProRes 4444 XQ	80 / 80 35 120 90 60	120 / 165 80 120 120 120
4.6K 16:9	28.0 x 15.7 mm 1.102 x 0.618"	32.1 mm 1.264"	4.6K (4608 x 2592)	ARRICORE ARRIRAW ProRes 422 HQ ProRes 4444 ProRes 4444 XQ	100 / 110 45 150 110 70	150 / 200 95 150 150 140
4K 16:9	24.9 x 14.0 mm 0.980 x 0.551"	28.6 mm 1.125"	4K (4096 x 2304)	ARRICORE ARRIRAW ProRes 422 HQ ProRes 4444 ProRes 4444 XQ	125 / 125 55 150 135 90	150 / 210 125 150 150 150
3.8K 16:9	23.3 x 13.1 mm 0.918 x 0.516"	26.8 mm 1.054"	UHD (3840 x 2160)	ARRICORE ARRIRAW ProRes 422 HQ ProRes 4444 ProRes 4444 XQ	145 / 145 65 150 150 105	150 / 240 140 150 150 150
3.8K 2.39:1	23.3 x 9.8 mm 0.918 x 0.386"	25.30 mm 0.998"	3.8K (3840 x 1608)	ARRICORE ARRIRAW ProRes 422 HQ ProRes 4444 ProRes 4444 XQ	195 / 195 85 240 210 140	240 / 240 190 240 240 240
3.3K 6:5	20.22 x 16.95 mm 0.796 x 0.693"	26.4 mm 1.039"	3.3K (3328 x 2790)	ARRICORE ARRIRAW ProRes 422 HQ ProRes 4444 ProRes 4444 XQ	120 / 125 55 120 120 90	120 / 210 120 120 120 120
2K 16:9 S16	12.4 x 7.0 mm 0.490 x 0.276"	14.2 mm 0.561"	2K (2048 x 1152)	ARRICORE ARRIRAW ProRes 422 HQ ProRes 4444 ProRes 4444 XQ	330 / 505 230 330 330 330	330 / 660 330 330 330 330
HD 16:9 S16	11.7 x 6.6 mm 0.461 x 0.260"	13.43 mm 0.528"	HD (1920 x 1080)	ARRICORE ARRIRAW ProRes 422 HQ ProRes 4444 ProRes 4444 XQ	330 / 590 260 330 330 330	330 / 660 330 330 330 330

2.5 Dimensional Drawings

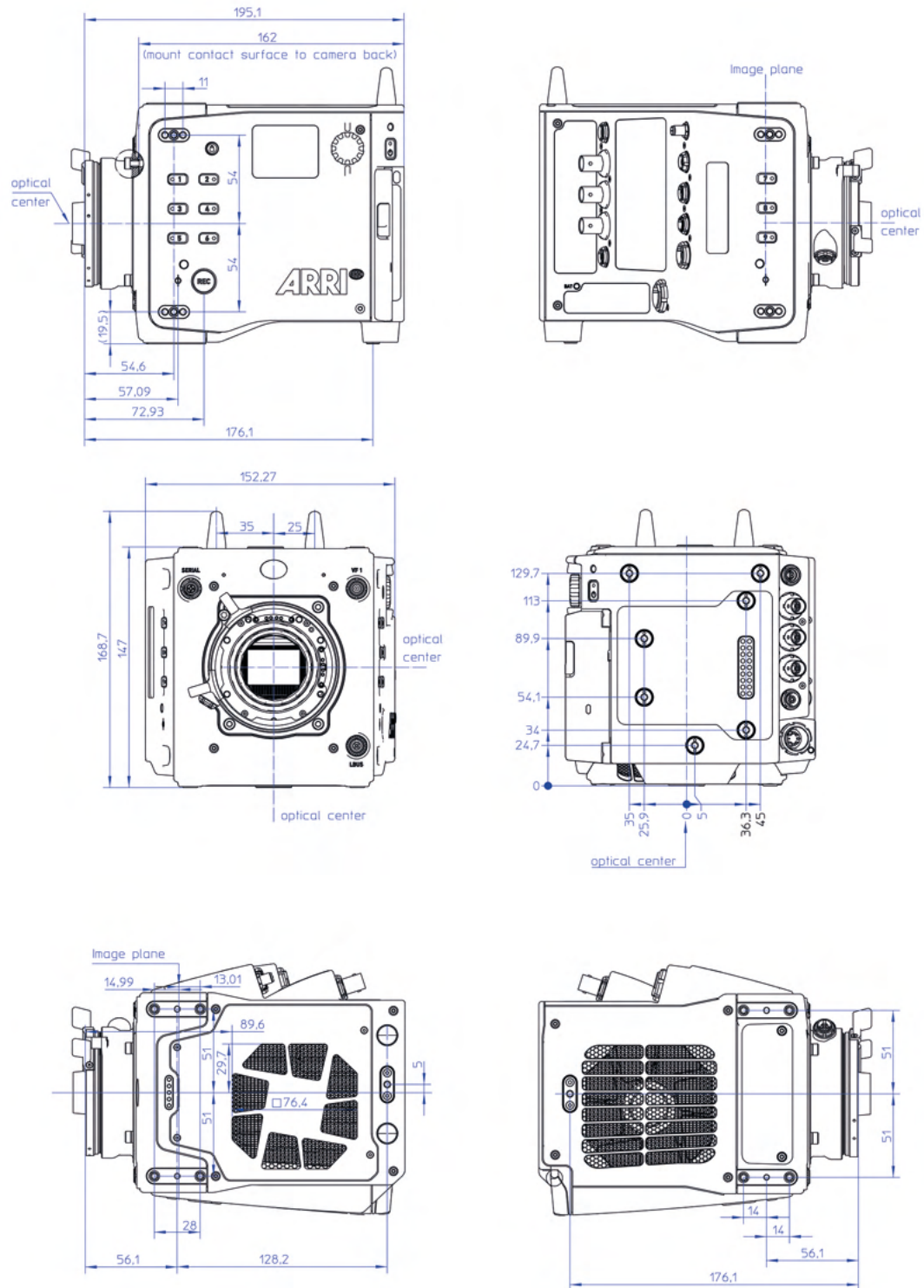

Camera body with LPL lens mount. All dimensions in mm. Not to scale.

2.6 Scope of Delivery and Warranty



NOTICE

The packaging consists of recyclable materials. For the sake of the environment, discard the packaging material at an applicable disposal site. Always store, ship, and dispose according to local regulations. ARRI is not liable for consequences from inadequate storage, shipment, or disposal.

On delivery, please check if package and content are not damaged. Never accept a damaged or incomplete delivery.

K1.0053455 ALEXA 35 Xtreme Body & LPL Lens Mount Set

A complete delivery includes:

- 1x K1.0053455 ALEXA 35 Xtreme camera body
- 1x K2.0018983 LPL Mount (LBUS)
- 2x WiFi Antennas

Warranty

For scope of warranty, please speak to your local ARRI Service Partner. ARRI is not liable for consequences from inadequate shipment, incorrect use, or use of third-party products.

2.7 Certifications and Safety Standards

Approval Information

The ARRI ALEXA 35 is approved for use in Europe (CE), USA (FCC), UK (UCKA), Kanada (ICES), Japan (MIC), Australien (SDoC), and where one of those declarations are accepted.

The import and use in other countries may be subject to legal, official or regulatory requirements and regulations. It is the importer's or the user's responsibility, prior to importation or use, to inform themselves of the applicable legal, regulatory and administrative requirements and regulations and to ensure compliance with these requirements and regulations. This includes the applying for and obtaining of all necessary approvals or registrations.

As far as reasonable and legally possible, ARRI will support requests in relation to such applications by providing technical documents or declarations. As an importer or user, you confirm that you are familiar and comply with the legal, regulatory, and administrative requirements and regulations that apply in the countries to which you ship or use the products. You further confirm that you will arrange for any necessary registrations, enrollments, or authorizations that are required in such countries.

You release ARRI from all obligations resulting from any legislative, regulatory, or administrative requirements regarding import or use of the products, except in countries where ARRI has obtained a registration or certification. You agree to indemnify, defend, and hold ARRI harmless from any and all claims, damages, losses, liabilities, costs, and expenses (including reasonable fees of attorneys and other professionals) that may arise out of a demand on ARRI in connection with your obligations mentioned above.

United States of America



This device complies with Part 15 of the FCC Rules. Operation is subject to the following two conditions:

- (1) This device may not cause harmful interference, and
- (2) This device must accept any interference received, including interference that may cause undesired operation.

Changes or modifications not expressly approved by the party responsible for compliance could void the user's authority to operate the equipment.

Canada

This device complies with Industry Canada license - exempt RSS standard(s). Operation is subject to the following two conditions: (1) This device may not cause interference, and (2) this device must accept any interference, including interference that may cause undesired operation of the device.

Le présent appareil est conforme aux CNR d'Industrie Canada applicables aux appareils radio exempts de licence. L'exploitation est autorisée aux deux conditions suivantes: (1) l'appareil ne doit pas produire de brouillage, et (2) l'utilisateur de l'appareil doit accepter tout brouillage radioélectrique subi, même si le brouillage est susceptible d'en compromettre le fonctionnement.

South Korea



Company Name: Arnold & Richter Cine Technik GmbH & Co. Betriebs KG
 Equipment Name: Digital Camera System ALEXA
 Modul Name: ALEXA 35 Xtreme
 Manufacturing Date: See product type label
 Manufacturer / Country: Arnold & Richter Cine Technik GmbH & Co. Betriebs KG / Germany
 Certification no.: R-R-ARg-ALEXA35Xtreme

List of Radio Channels

This equipment uses the following radio frequencies for communication with other equipment:

No	Frequency	No	Frequency
1	2.412 GHz	56	5.280 GHz
2	2.417 GHz	60	5.300 GHz
3	2.422 GHz	64	5.320 GHz
4	2.427 GHz	100	5.500 GHz
5	2.432 GHz	104	5.520 GHz
6	2.437 GHz	108	5.540 GHz
7	2.442 GHz	112	5.560 GHz
8	2.447 GHz	116	5.580 GHz
9	2.452 GHz	120	5.600 GHz
10	2.457 GHz	124	5.620 GHz
11	2.462 GHz	128	5.640 GHz
36	5.180 GHz	132	5.660 GHz
40	5.200 GHz	136	5.680 GHz
44	5.220 GHz	140	5.700 GHz
48	5.240 GHz	144	5.720 GHz
52	5.260 GHz		



NOTICE

The operation of Wi-Fi in the 5 GHz band is only permitted for indoor use.

EU Declaration of Conformity



Arnold & Richter Cine Technik GmbH & Co. Betriebs KG

Business Unit Camera Systems, Herbert-Bayer-Str. 10, D-80807 München

EU-Konformitätserklärung EU-Declaration of Conformity

Markenname / Brand Name: ARRI

Produktbezeichnung / Product Description:

Digitalkamerasystem / Digital Camera System:

ARRI Alexa 35 XTREME

Die bezeichneten Produkte stimmen mit den Vorschriften folgender Europäischer Richtlinie überein:

The designated products conform to the specifications of the following European directive:

Richtlinie 2014/53/EU des Europäischen Parlaments und des Rates vom 16. April 2014 zur Harmonisierung der Rechtsvorschriften der Mitgliedstaaten über die Bereitstellung von Funkanlagen auf dem Markt - OJ L 153, 22.5.2014, S. 62–106

Directive 2014/53/EU of the European Parliament and the Council of 16 April 2014 on the harmonisation of the laws of the Member States relating to the making available on the market of radio equipment - OJ L 153, 22 May 2014, p. 62–106

Richtlinie 2011/65/EU des Europäischen Parlaments und des Rates vom 8. Juni 2011 zur Beschränkung der Verwendung bestimmter gefährlicher Stoffe in Elektro- und Elektronikgeräten und Delegierte Richtlinie (EU) 2015/863 der Kommission vom 31.03.2015.

Directive 2011/65/EU of the European Parliament and the Council of June 8, 2011 on the restriction of the use of certain hazardous substances in electrical and electronic equipment and the Commission Delegated Directive (EU) 2015/863 of March 31, 2015.

Die Übereinstimmung mit den Richtlinien erfolgte unter Anwendung nachfolgend genannter Normen:

The compliance with the requirements of the European Directives was proved by the application of the following standards:

- EN 55032:2015 + AC:2016 + A1:2020 + A11:2020 ; EN 55035:2017 + A11:2020; ETSI EN 301 489-1 V2.2.3 (additionally covered version: V1.9.2) ; ETSI EN 301 489-17 V3.3.1
- ETSI EN 300 328 V2.2.2 (partly) ; ETSI EN 301 893 V2.1.1 (partly);
- EN IEC 62368-1:2020 + A11:2020; EN IEC 62368-3:2020
- EN 300 328 V2.2.2, EN 300 440 V2.1.1, EN 301 893 V2.1.1, EN 300 328 V2.1.1
- EN 62311:2008
- EN 62368-1:2018

Die alleinige Verantwortung für die Ausstellung dieser Konformitätserklärung trägt der Hersteller.

The manufacturer bears sole responsibility for issuing this declaration of conformity.

München, den 18.06.2025

Gezeichnet/signed: David Bernbach

David Bernbach
Managing Director

Gezeichnet/signed: Stefan Rapp

Stefan Rapp
Senior Vice President, Chief Procurement Officer and Quality
Management ARRI Group

Arnold & Richter Cine Technik GmbH & Co. Betriebs KG
Herbert-Bayer-Str. 10, D-80807 München
Steuer-Nr. 143/502/20276
USt-ID: DE129725260 WEEE-Reg.-Nr. DE 48968492
Bayern LB: KTO: 1 114 368 BLZ: 700 500 00
HypoVereinsbank: KTO: 7 940 009 BLZ: 700 202 70

Sitz: München, Register: Amtsgericht München, HRA-Nr. 57918
Persönlich haftende Gesellschafterin: Arnold & Richter Cine Technik GmbH
Sitz: München, Register: Amtsgericht München, HRB-Nr. 54477
Geschäftsführung: David Bernbach • Christian Richter • Walter Trauninger
Swift/BIC: BYLADEMM IBAN: DE64 7005 0000 0001 1143 68
Swift/BIC: HYVEDEMMXXX IBAN: DE63 7002 0270 0007 9400 09

Tel.: +49 (89) 3809 0
Fax: +49 (89) 3809 1244
www.arri.com

Arnold & Richter Cine Technik GmbH & Co. Betriebs KG



Business Unit Camera Systems, Herbert-Bayer-Str. 10, D-80807 München

**Appendix I to
EU-Declaration of Conformity
dated from 2025/06/18**

This appendix refers to the following products:

• **ARRI Alexa 35 XTREME**

and lists all types of antennas applicable for this device.

Lfd. Nr. Item	Hersteller Manufacturer	Bezeichnung Model name	Gain (dBi)	Strahlungsdiagramm Radiation pattern	Antennentyp Type	Anschluss Connector
for ECS white radio RF module EMIP400s						
1	Proant	333 (Ex-it 2400 Foldable)	2.0	Omni-directional	Dipole	Reverse SMA
For WiFi 2.4 and 5 GHz RF Module ST60-2230						
2	Wanshih Electronic	WSS002	2.0	Omni-directional	Dipole	Reverse SMA

Munich, 18.06.2025

Gezeichnet/signed: David Bermbach
David Bermbach
Managing Director

Gezeichnet/signed: Stefan Rapp
Stefan Rapp
Senior Vice President, Chief Procurement Officer and Quality Management ARRI Group

Arnold & Richter Cine Technik GmbH & Co. Betriebs KG
Herbert-Bayer-Str. 10, D-80807 München
Steuer-Nr. 143/502/20276
USt-ID: DE129725260 WEEE-Reg.-Nr. DE 48968492
Bayern LB: KTO: 1 114 368 BLZ: 700 500 00
HypoVereinsbank: KTO: 7 940 009 BLZ: 700 202 70

Sitz: München, Register: Amtsgericht München, HRA-Nr. 57918
Persönlich haftende Gesellschafterin: Arnold & Richter Cine Technik GmbH
Sitz: München, Register: Amtsgericht München, HRB-Nr. 54477
Geschäftsführung: David Bermbach • Christian Richter • Walter Trauninger
Swift/BIC: BYLADEMM IBAN: DE64 7005 0000 0001 1143 68
Swift/BIC: HYVEDEMMXXX IBAN: DE63 7002 0270 0007 9400 09

Tel.: +49 (89) 3809 0
Fax: +49 (89) 3809 1244
www.arri.com

3 Safety Instructions

This safety information is in addition to the specific operating instructions in general and shall be strictly observed for safety reasons. Read and understand all safety and operating instructions before you operate or install the device. Retain all safety and operating instructions for future reference. Always follow the instructions in this and all documents supplied with the device to avoid injury to yourself or others and damage to the device or other objects.

Assembly and operation should only be carried out by approved persons. Only use the tools, materials and procedures recommended in this document. For the correct use of other equipment, see the manufacturer's instructions.

3.1 Structure of Safety and Warning Messages

These instructions use safety instructions, warning symbols and signal words to draw your attention to different levels of risk:



DANGER

DANGER indicates an imminent danger. If not avoided, death or serious injury will result.

Always follow the recommended measures to avoid this hazardous situation.



WARNING

WARNING indicates a possibly imminent danger. If not avoided death or serious injury may result.

Always follow the recommended measures to avoid this potentially hazardous situation.



CAUTION

CAUTION indicates a potentially imminent danger. If not avoided, slight or minor injuries may result.

Always follow the recommended measures to avoid this potentially hazardous situation.



NOTICE

NOTICE indicates a potentially harmful situation. If not avoided, the equipment or something in its surrounding may be damaged.

Always follow the recommended measures to avoid this situation.

HINT

Not relevant to safety, **HINT** provides additional information to clarify or simplify a procedure.

3.2 Warning Symbols and Product Labels



General warning sign



Warning of electrical voltage



Warning of hot surfaces



Warning of sharp element



Warning of the risk of crushing



Warning of obstacles on the ground



Please read all instructions carefully before using the product for the first time.



Direct Current symbol found on electronics requiring or producing DC power.

3.3 General Safety Instructions



WARNING

Operation with Obvious Damage

Risk of electric shock and fire caused by short circuit.

- ▶ Do not use the device when a cable or, housing has a visible damage.
- ▶ Use the type of power source indicated in the manual.
- ▶ Always hold the power connector and not the cable to disconnect the power cable.
- ▶ Do not run a cable over sharp edges (e.g. sheet metal, profile or other cut edges). A damaged cable can cause electric shock, short circuit, or fire.
- ▶ Do not bypass, remove, or deactivate any safety feature from the device (incl. warning stickers or paint marked screws).
- ▶ Do not try to repair the device. Repairs can only be carried out by an approved ARRI service center.



WARNING

Falling System Parts

Do not built up or assemble the ALEXA 35 wrong. It can fall and cause serious injury to persons and damage to the device or property.

- ▶ Installation and operation shall only be carried out by approved persons who know the device. Obey the accident prevention regulations.
- ▶ Never put the device on a not stable trolley or hand truck, stand, tripod, bracket, table, or any other not stable support device.
- ▶ Always place the device on a dedicated support device.
- ▶ Safe the device and its accessories against falling and tipping over. Obey the general and local safety regulations.
- ▶ Always use a suitable safety rope when you use the device above floor level (i.e. on cranes).



WARNING

Positioning the ALEXA 35 on an Inclined or not safe Surface

Risk of injury caused by the ALEXA 35 system tipping over.

- ▶ Obey the accident prevention regulations.
- ▶ Put the camera system on level and stable ground.
- ▶ Do not put the camera system on an unstable trolley or hand truck, stand, tripod, bracket, table or any other unstable support device.
- ▶ Always put the camera system on a dedicated support device.
- ▶ Use only accessories approved by ARRI. The use of accessories not approved by ARRI is at your own risk. Obey all related safety regulations.



WARNING

Overloading the ALEXA 35 by Persons or Objects

Risk of injury caused by the ALEXA 35 tipping over.

- ▶ Do not lean on the system.
- ▶ Do not put any not approved objects on the system.
- ▶ Do not hang any not approved objects on the system.
- ▶ Use only accessories approved by ARRI. The use of accessories not approved by ARRI is at your own risk. Obey all related safety regulations.



WARNING

Changing the Lens Mount while the Camera is Energized

Risk of electric shock and permanent damage to the camera and lens mount.

- ▶ Always de-energize the camera and disconnect all power supplies before you change the lens mount.



WARNING

Connected Cable on the Floor

Risk of injury by tripping, falling, or slipping over a connected cable.

- ▶ Always attach all cables connected to the system correctly.
- ▶ Always install all cables in a way that nobody can trip over them.
- ▶ Use a cable duct or attach cables with adhesive tape.
- ▶ Always remove all cables from the system before you move it.



CAUTION

Use of the ALEXA 35 or ALEXA 35 Accessories in a Humid Environment and with Condensation

When you move the device and the accessories from a cool to a warm location or when the device is used in a damp environment, condensation may form inside the device, and on internal or external electrical connections. Do not operate the device while condensation is present. It bears risk of electric shock and/or fire caused by a short circuit.

- ▶ Do not operate the device and accessories when condensation occurs.
- ▶ When you move the device and accessories from a cool to a warm environment, wait for some time for the components to warm up.
- ▶ Find a warmer storage location to decrease the risk of condensation.





CAUTION

Hot Surfaces on ALEXA 35 and ALEXA 35 Accessories



During extended operation, high data rates and/or operation at high ambient temperatures, the device's surface and the area around the fan outlet can get hot. Direct sunlight can result in device housing temperatures above 60° C (140° F).

- ▶ Do not put covers on, clog or block the fan in- or outlets while the device is powered.
- ▶ Do not put the device system near any heat sources during operation.
- ▶ At ambient temperatures above 25° C (77° F), prevent the device and accessories from being exposed to direct sunlight.



CAUTION

Hot Surfaces on Recording Media



During extended operation, high data rates and/or operation at high ambient temperatures, the recording media in the camera can get hot to the touch and can cause pain or burns if held for too long directly after removal.

- ▶ Do not handle the recording media for longer than three seconds and remove it quickly but carefully.
- ▶ Consider wearing protective gloves when removing the recording media or let it cool down beforehand.
- ▶ Do not put any labels or adhesive tape on the recording media (especially the side facing the camera body). The recording media shall have full contact to the thermal surface to ensure proper heat conduction.



WARNING

Rotating Lens Motor



Risk of crushing fingers and capturing and unraveling long hair, jewelry and/or clothing.

- ▶ Make sure that the lens motor is properly attached to the lens.
- ▶ Do not touch the lens motor gears while they are moving.
- ▶ Keep hair and loose clothing away from the motor gear teeth.
- ▶ Keep cables connected to the camera away from the motor gear teeth.



CAUTION

Unhealthy Posture or too much Physical Exertion During Camera Operation

Using the camera in shoulder mode, on portable stabilizer systems etc., as well carrying for transport in general bears risk of permanent long term physical damage.

- ▶ Keep an ergonomic posture when operating and carrying the camera.



NOTICE

High Energy Light Sources

Permanent damage to the camera sensor and/or the viewfinder display.

- ▶ Do not point the camera sensor into direct sunlight, very bright light sources or high energy light sources (e.g. laser beams).
- ▶ Do not point the viewfinder eyepiece into direct sunlight, very bright light sources or high energy light sources (e.g. laser beams).



NOTICE**Open Lens Mount**

When no lens or lens cap is attached to the camera, dirt and dust particles can go into the camera and settle on the sensor cover glass. Particles on the sensor cover glass can later be visible in the recordings made by the camera.

- ▶ Put the protective cap on the lens mount, when no lens is attached to the camera.
 - ▶ Contact ARRI Service to examine the camera if undefined spots show in the image.
-



NOTICE**Connection of Onboard Monitor**

Damage to the SDI driver chip caused by power surge.

- ▶ Always make sure to plug in the power cable first and then connect the BNC cable. As soon as the power and BNC cables are connected, you can switch the camera or the accessories on and off.
 - ▶ Always make sure to disconnect the BNC cable first and then disconnect the power cable.
 - ▶ Only use shielded power cables to power accessories that connect to the camera with a BNC cable. When the plus pin only connects on a shielded power cable, the shield will act as the power return and therefore not damage the SDI output.
-

4 Product Overview

4.1 Camera Layout

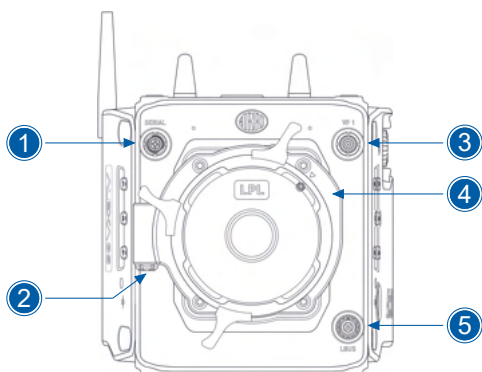

- 1 SERIAL Connector
- 2 LBUS Connector (on lens mount)
- 3 VF 1 Viewfinder Connector
- 4 Lens Mount (here: LPL Mount)
- 5 LBUS Connector

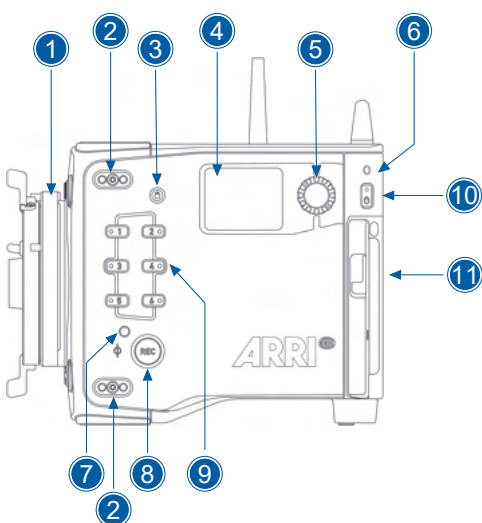

- 1 Lens Mount (here: LPL Mount)
- 2 Mounting Points for Accessories
- 3 LOCK Button
- 4 Side Display
- 5 Side Display Jog Wheel
- 6 Rear Camera Status LED
- 7 Left Camera Status LED
- 8 REC Button
- 9 User Buttons 1 - 6
- 10 POWER Button
- 11 Camera Identification Label

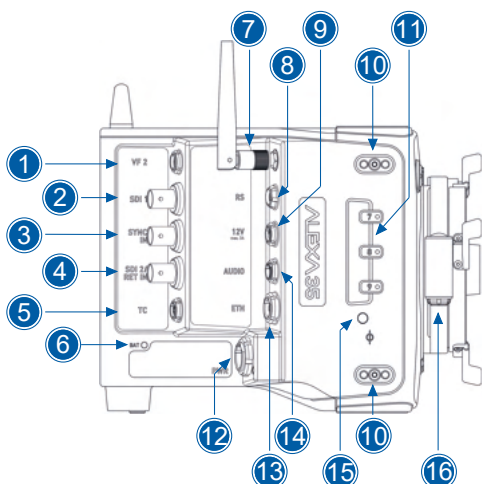

- 1 VF 2 Viewfinder Connector
- 2 SDI 1 Connector
- 3 SYNC IN Connector
- 4 SDI 2 / RET IN Connector
- 5 TC (Timecode) Connector
- 6 BAT LED
- 7 ECS White Radio Antenna Connector
- 8 RS Connector
- 9 12 V Connector
- 10 Mounting Points for Accessories
- 11 User Buttons 7 - 9
- 12 PWR Connector
- 13 ETH Connector
- 14 AUDIO Connector
- 15 Right Camera Status LED
- 16 LBUS Connector (on Lens Mount)

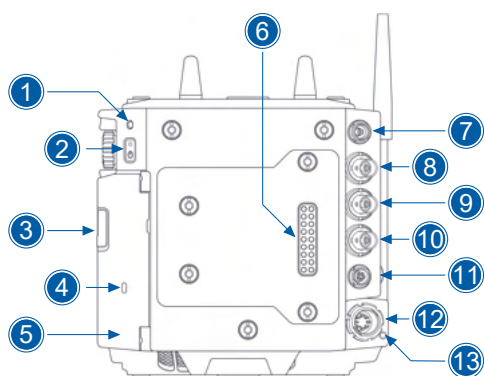

- 1 Rear Camera Status LED
- 2 POWER Button
- 3 Media Door Release
- 4 Media LED Window
- 5 Media Door
- 6 Camera Rear Interface
- 7 VF 2 Viewfinder Connector
- 8 SDI 1 Connector
- 9 SYNC IN Connector
- 10 SDI 2 / RET IN Connector
- 11 TC (Timecode) Connector
- 12 PWR Connector
- 13 PWR Status LED

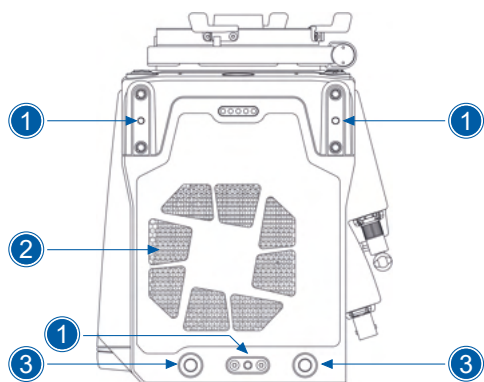

- 1 Top Attachment Points
- 2 Fan Outlet
- 3 WiFi Antenna Connector

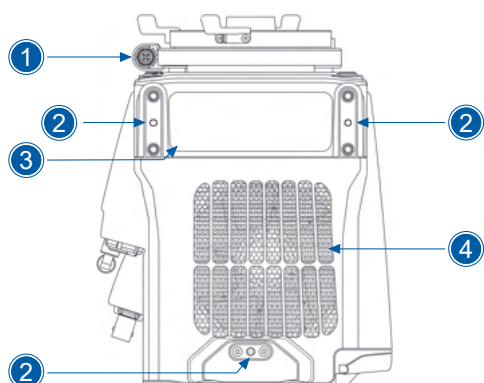

- 1 LBUS Connector (on Lens Mount)
- 2 Bottom Attachment Points
- 3 Conformity Label
- 4 Fan Intake

Camera Media Bay

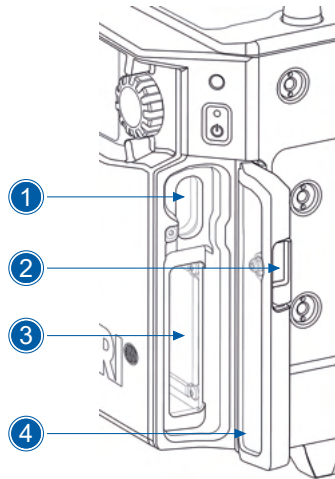

- 1 USB-C Connector
- 2 Media Door Release
- 3 Recording Media Slot
- 4 Media Door

5 Mounting and Assembly

5.1 Attachment of Accessories



WARNING

Falling System Parts



Do not built up or assemble the ALEXA 35 wrong. It can fall and cause serious injury to persons and damage to the device or property.

- ▶ Installation and operation shall only be carried out by approved persons who know the device. Obey the accident prevention regulations.
- ▶ Never put the device on a not stable trolley or hand truck, stand, tripod, bracket, table, or any other not stable support device.
- ▶ Always place the device on a dedicated support device.
- ▶ Safe the device and its accessories against falling and tipping over. Obey the general and local safety regulations.
- ▶ Always use a suitable safety rope when you use the device above floor level (i.e. on cranes).



CAUTION

Incorrect Attached Accessories



Mounting the ALEXA 35 poses a crushing hazard for your fingers and/or hands.

- ▶ Read the operating manual before you mount the ALEXA 35.
- ▶ Use the tools specified by the manufacturer for mounting.

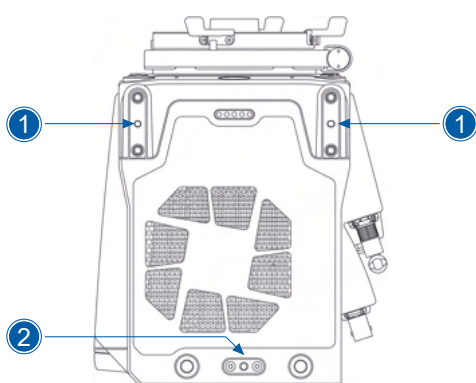

Top Attachment Points

The camera has two primary accessory attachment points (1) on the camera top to attach accessories like

- Low Mode Support LMS-4 (K2.0024062)
- Universal Adapter Plate UAP-3 (K2.0034179)
- Lightweight Camera Handle LCH-1 (K2.0024066)

Use the auxiliary attachment point (2) to secure the Top Extension Bracket TEB-1 (K2.0024062) when used in combination with LMS-4 or UAP-3.

Use a 3.0 mm Allen/hex key to attach the accessories. Tighten screws crosswise.

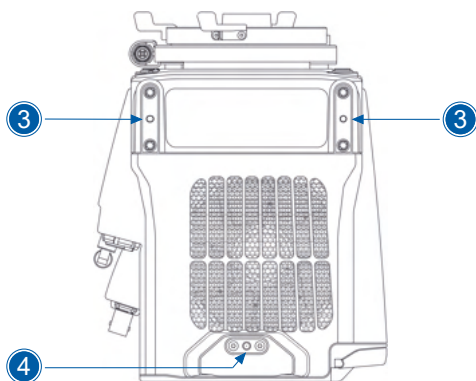

Bottom Attachment Points

The three attachment points on the camera bottom (3, 4) are used to attach the Balance Utility Dovetail BUD-1 (K2.0034180).

Use a 3.0 mm Allen/hex key to attach the Balance Utility Dovetail. Tighten screws crosswise.

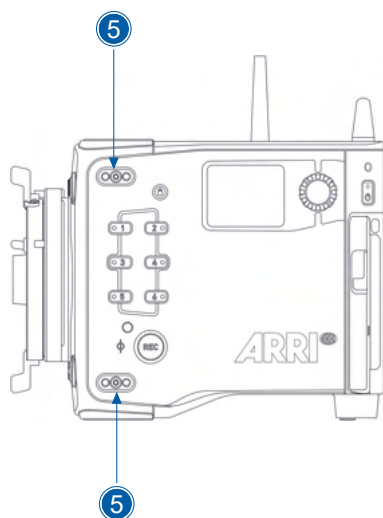

Side Attachment Points

The camera has two accessory attachment points (5) each on the camera left and the camera right side to attach:

- Camera Side Bracket CSB-1L (K2.0033573)
- Camera Side Bracket CSB-1R (K2.0033571)

Use a 3.0 mm Allen/hex key to attach the side brackets. Tighten screws crosswise.

5.2 Power Supply



NOTICE

Incorrect Handling of Cables

Risk of damage to the device.

- ▶ Operate the device using only the type of power source indicated in this document. Do not supply power outside the specified voltage range.
- ▶ Always unplug the power cable by gripping the power plug, not the cable.
- ▶ Always keep the connectors accessible so that the cable can be unplugged quickly in case of emergency.
- ▶ Always properly secure cables connected to the device to avoid pinching or tripping.
- ▶ Do not use any accessories, cables or attachments that are not recommended by ARRI, as they can damage any connected devices and invalidate the warranty.

The camera accepts an input voltage range from 20.5 to 33.6 V DC. It can be energized through the PWR connector or through the BAT interface on the camera rear using a battery adapter and an applicable battery.

Power In (PWR) Connector

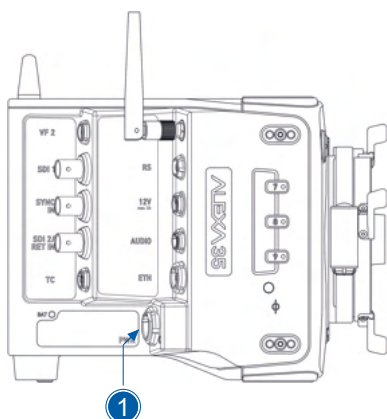

The PWR 8pin LEMO connector (1) is at the right side of the camera. Use KC50-S (K2.75007.0) or KC50-SP-S (K2.0001275) power cables to connect the camera to a power supply.

Onboard Battery (BAT) Interface



NOTICE

Incorrect Handling of Batteries

Risk of damage to the camera system.

- ▶ Use only batteries with a capacity of 86 Wh or more to prevent damage to the battery and unpredictable camera behavior. Any camera-battery combination should be tested prior to use, especially when accessories are powered through the camera.
- ▶ Use only batteries with a minimum current of 12 A for a camera setup without any accessories. When you use accessories like motors or monitors, select batteries with higher current according to the power draw of the accessories.
- ▶ Battery adapters shall be installed by approved personnel only.

You can use different battery adapters with the camera, like:

- B-Mount Battery Adapter (K2.0023751)
to use B-Mount batteries in 7s or 8s configuration (25.2 V and 28.8 V DC nominally).
- Battery Adapter Back BAB-LF (K2.0034204)
to use any 24 V or 26 V DC power solution that can attach to the rear of the ALEXA 265.

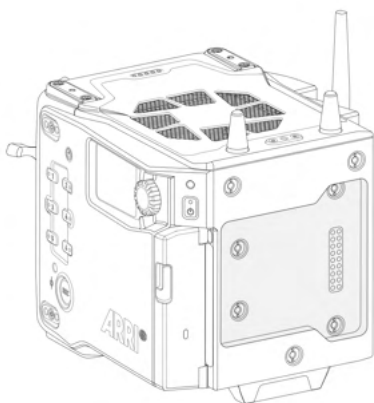

The battery adapters attach to the recessed area at the rear of the camera with four captive M4 screws.

Use a 3.0 mm Allen/hex key to attach the battery adapters. Tighten screws crosswise.

De-energize the camera before installation.

Power Management

When you use the PWR connector and an onboard battery adapter at the same time, the camera's power management system ensures that the power source with the highest voltage level is used. When the voltage level of one power source drops below the level of the other, or a power source is disconnected from the camera, the power management system automatically switches to the other power source, avoiding shutdown of the camera.

The camera supports to prioritize which power source (PWR or BAT) should be used primarily and which one should serve as backup. Available choices are "Highest Voltage" (default), "PWR (power in)", or "BAT (on-board battery)".

5.3 Viewfinder Connection

The ARRI ALEXA 35 has two custom CoaXPress viewfinder connectors. One is at the camera front (labelled VF 1) and one is on the camera rear (right side, labelled VF 2).

The Multi Viewfinder MVF-2 connects to the camera with a custom CoaXPress cable. The cable center pin and shield transport power, video, audio, and data. The VF connector does not have a key. The VF cable connector connects regardless of its orientation. It supports hot plugging of the viewfinder.

6 Basic Operation

6.1 Menu Operation

The camera settings are organized in 11 submenus:

Recording
Media
Monitoring
Image

System
Setup
User Buttons
Metadata

Lens & ECS
Info
Alerts

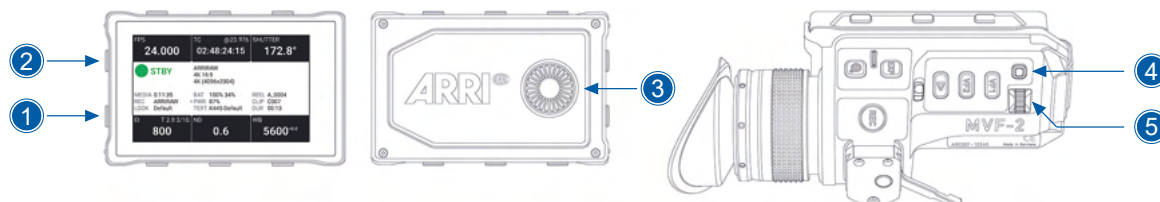

- | | | | | | |
|---|--------------------|---|------------|---|------------|
| 1 | MENU / BACK Button | 3 | Jog Wheel | 5 | User Wheel |
| 2 | HOME / LIVE Button | 4 | SET Button | | |

While the HOME screen is displayed, push the *HOME / LIVE* button (2) or swipe to the right to show the live view.

- While the HOME screen is shown, push the *MENU / BACK* button (1) or swipe to the left to access the camera menu.
- Turn the jog wheel (3) or the user wheel (5) to scroll up or down to select a menu entry:

Entries with a ">" at the end navigate to a sub menu. To navigate to a sub menu, push the jog wheel center or the *SET* button (4). To go to a higher menu level, push the *MENU / BACK* button (1).

You can edit entries with a value directly. To edit a value, push the jog wheel center or the *SET* button (4), then turn the jog wheel or user wheel to select the value. Push the jog wheel center or *SET* button (4) to confirm the change or push the *HOME / LIVE* button (2) to abort and exit.

You can activate and de-activate entries with a check box. Push the jog wheel center or the *SET* button (4) to activate or de-activate a setting.

To leave the menu push the *HOME / LIVE* button (2) or swipe to the right.

The jog wheel and the user wheel + *SET* button (4) have the same functionality.

6.2 Energize and De-energize

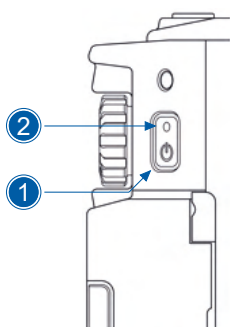

The backlit *POWER* button (1) is at the rear left of the camera. It is illuminated when the supplied power is in the correct range.

While the camera is booting up, the boot status LED (2) is flashing blue. As soon as the camera has finished the boot process, the boot status LED turns to solid blue.

- To energize the camera, push the *POWER* button (1).
- To de-energize the camera, push and hold the *POWER* button (1) until the camera is de-energized.

7 Cleaning and Repair

7.1 Cleaning Instructions



NOTICE

Improper Cleaning Procedure

Risk of damage of surfaces.

- ▶ Only use the cleaning agents specified in this section.
- ▶ Do not use any strong or aggressive cleaning detergents like Methanol, Acetone, Benzine or acids. These chemicals may dissolve imprinted labels or the paint on the housing and damage highly polished surfaces.
- ▶ During cleaning of the product, always make sure that protective covers are in place.
- ▶ Do not moisten connectors when cleaning the product.
- ▶ Avoid touching any connector pins when cleaning the product.
- ▶ Avoid wiping dry connector pins with a dry cloth, especially if the surface is not clean.
- ▶ Avoid wiping connector pins without air blow dusting first. If particles or connector pins are electrostatically charged, it may improve dusting efficiency to use deionized air.
- ▶ Compressed air should not be used on the housing.



NOTICE

Refer to the lens manufacturer's instructions for cleaning lenses .

Recommended Cleaning Agents

- Water
- Glass Cleaner
- Isopropyl Alcohol

Cleaning Information Camera Body

Area	Cleaning Procedure
Camera Body	Clean the camera body, mechanical and electronic accessories with a soft, lint free cleaning cloth and some water or glass cleaner. Only when really necessary, e.g. to remove residues of camera tape, isopropyl alcohol should be used.
Narrow spaces and gaps	Use a manual air blower, cotton swabs or a soft brush to remove dust particles from narrow spaces, gaps or connectors.
Ventilation channel	Clean the ventilation channel using a vacuum cleaner at low level.

Cleaning Information Sensor Cover Glass

If the sensor cover glass has been contaminated by particles or smear, special optical cleaning kits should be used for dirt removal under very high care. If the contamination cannot be removed, the camera should be taken to an ARRI Service center for cleaning.

7.2 Repair



WARNING



Repairs Carried out by not Approved Persons

Risk of electric shock and fire hazard caused by short circuit.

- ▶ Do not try to repair the device yourself. Repairs shall be carried out by an approved ARRI service center.

For repairs and maintenance work on the device, please contact the [ARRI Service](#).

8 Transportation, Storage and Disposal

8.1 Transportation and Storage



NOTICE

Improper Packing and Transportation of the Device

Risk of damage to the device.

- ▶ Follow the specified environmental conditions.
- ▶ Only transport the device and accessories in suitable cases.
- ▶ Follow the instructions for transport and storage in this section.

The device can be damaged if not transported and stored properly. Please take note of the following guidelines.

Transportation Guidelines

- Disconnect all cables and power sources from the device.
- Always transport the device in a suitable case.
- Do not expose the device to severe shocks.

Storage Guidelines

- Disconnect all cables and power sources from the device.
- Always store the device in a suitable case.
- Do not store the device outside of the specified ambient temperature range.
- Do not store the device in places where it may be subject to extreme temperatures, direct sunlight, high humidity, severe vibration, dust or strong magnetic fields.

8.2 Disposal



NOTICE

You can return the product to the manufacturer Arnold & Richter Cine Technik GmbH & Co. Betriebs KG for disposal.

When you dispose third party accessories, please observe the instructions of the relevant manufacturer.



This product falls within the scope of Directive 2012/19 / EU OF THE EUROPEAN PARLIAMENT AND OF THE COUNCIL of June 4, 2012 on waste electrical and electronic equipment (WEEE II).

Accordingly, this product shall not be disposed of with household waste. There are the respective country-specific disposal rules that must be observed.

9 Licensed Patents

Country	Patent Number	Country	Patent Number	Country	Patent Number
<i>BE</i>	<i>3200455</i>	<i>IE</i>	<i>3461307</i>	<i>EP</i>	<i>3652944</i>
<i>CN</i>	<i>107018430</i>	<i>JP</i>	<i>7046325</i>	<i>FR</i>	<i>3652944</i>
<i>DE</i>	<i>602016005233</i>	<i>KR</i>	<i>10-2400514</i>	<i>GB</i>	<i>3652944</i>
<i>EP</i>	<i>3200455</i>	<i>LU</i>	<i>3461307</i>	<i>IE</i>	<i>3652944</i>
<i>FR</i>	<i>3200455</i>	<i>MX</i>	<i>408659</i>	<i>JP</i>	<i>7128580</i>
<i>GB</i>	<i>3200455</i>	<i>NL</i>	<i>3461307</i>	<i>KR</i>	<i>10-2364942</i>
<i>JP</i>	<i>6431556</i>	<i>RU</i>	<i>2765654</i>	<i>LU</i>	<i>3652944</i>
<i>LU</i>	<i>3200455</i>	<i>US</i>	<i>11475600</i>	<i>US</i>	<i>10743014</i>
<i>NL</i>	<i>3200455</i>	<i>BE</i>	<i>3556097</i>	<i>US</i>	<i>11457232</i>
<i>US</i>	<i>10334246</i>	<i>BE</i>	<i>3556097</i>	<i>US</i>	<i>11438617</i>
<i>BE</i>	<i>3343921</i>	<i>CN</i>	<i>110383835</i>	<i>US</i>	<i>11736731</i>
<i>DE</i>	<i>602017055810</i>	<i>DE</i>	<i>602017051046</i>	<i>US</i>	<i>12149744</i>
<i>EP</i>	<i>3343921</i>	<i>EP</i>	<i>3556097</i>	<i>US</i>	<i>12132934</i>
<i>ES</i>	<i>2921227</i>	<i>ES</i>	<i>2908216</i>	<i>US</i>	<i>11949915</i>
<i>FR</i>	<i>3343921</i>	<i>FR</i>	<i>3556097</i>	<i>CN</i>	<i>114245989</i>
<i>GB</i>	<i>3343921</i>	<i>GB</i>	<i>3556097</i>	<i>BE</i>	<i>3984225</i>
<i>IE</i>	<i>3343921</i>	<i>IE</i>	<i>3556097</i>	<i>CH</i>	<i>3984225</i>
<i>IT</i>	<i>3343921</i>	<i>IT</i>	<i>3556097</i>	<i>DE</i>	<i>602020005917</i>
<i>LU</i>	<i>3343921</i>	<i>JP</i>	<i>6828184</i>	<i>ES</i>	<i>2937085</i>
<i>NL</i>	<i>3343921</i>	<i>KR</i>	<i>10-2361206</i>	<i>FR</i>	<i>3984225</i>
<i>AU</i>	<i>2018298758</i>	<i>LU</i>	<i>3556097</i>	<i>GB</i>	<i>3984225</i>
<i>BE</i>	<i>3461307</i>	<i>MO</i>	<i>J/007675</i>	<i>IE</i>	<i>3984225</i>
<i>BR</i>	<i>112020000415</i>	<i>NL</i>	<i>3556097</i>	<i>IT</i>	<i>3984225</i>
<i>CH</i>	<i>3461307</i>	<i>PL</i>	<i>3556097</i>	<i>LU</i>	<i>3984225</i>
<i>CN</i>	<i>110720222</i>	<i>US</i>	<i>10944972</i>	<i>MC</i>	<i>3984225</i>
<i>DE</i>	<i>602018017062</i>	<i>BE</i>	<i>3652944</i>	<i>NL</i>	<i>3984225</i>
<i>EP</i>	<i>3461307</i>	<i>CH</i>	<i>3652944</i>	<i>IL</i>	<i>288888</i>
<i>FR</i>	<i>3461307</i>	<i>CN</i>	<i>110915218</i>	<i>IN</i>	<i>552900</i>
<i>GB</i>	<i>3461307</i>	<i>DE</i>	<i>602018039979</i>	<i>US</i>	<i>11924470</i>

Patents written in *Italic* are patents within one family.

10 ARRI Service Contacts



Please see the current list of service partners at [service contacts](#).

Arnold & Richter Cine Technik GmbH & Co.
Betriebs KG
Herbert-Bayer-Str. 10
80807 Munich
Germany
+49 89 3809 2121
service@arri.de
Business hours:
Mo. - Fr. 09:00 - 17:00 (CET)

ARRI Inc. / East Coast
617 Route 303
NY 10913 Blauvelt
USA
+1 845 353 1400
service@arri.com
Business hours:
Mo. - Fr. 08:30 am - 05:30 pm (EST)

ARRI Inc. / West Coast
3700 Vanowen Street
CA 91505 Burbank
USA
+1 818 841 7070
service@arri.com
Business hours:
Mo. - Fr. 09:00 am - 05:00 pm (PT)

ARRI Canada Limited
76 Six Point Road
Etobicoke, ON M8Z 2X2
Canada
+1 416 255 3335
service@arri.com
Business hours:
Mo. - Fr. 08:30 am - 05:00 pm (EDT)

ARRI Australia Pty Ltd
Suite 2, Building B, 12 Julius Ave
NSW 2113 North Ryde
Australia
+61 2 9855 4305
service@arri.com.au
Business hours:
Mo. - Fr. 08:00 am - 05:00 pm (AEST)

ARRI Brasil Ltda
Rua Clodomiro Amazonas, 1158 - Lojas 45 e 46,
Vila Nova Conceição
São Paulo, SP 04537-901
Brasil
+55 1150419450
arribrasil@arri.com
Business hours:
Mo. - Fr. 09:00 am - 05:30 pm (BRT)

ARRI Hong Kong Limited
26/F Gravity, 29 Hing Yip Street
Kwun Tong, Hong Kong
P. R. China
+852 2571 6288
servicehk@arri.asia
Business hours:
Mo. - Fr. 09:00 am - 06:00 pm (HKT)

ARRI China (Beijing) Co. Ltd.
Chaowai SOHO Tower C, 6/F, 0628/0656,
Chaowai
Dajie Yi 6
Beijing
China
+86 10 5900 9680
service@arri.cn
Business hours:
Mo. - Fr. 09:00 am - 06:00 pm (CST)

ARRI CT Limited / London
2 Highbridge, Oxford Road
UB8 1LX Uxbridge
United Kingdom
+44 1895 457 000
service@arri-ct.com
Business hours:
Mo. - Thu. 09:00 am - 5:30 pm (GMT)
Fr. 09:00 am - 5:00 pm (GMT)

ARRI Korea Limited
42, World Cup buk-ro 1-gil, Mapo-gu
04031 Seoul
Korea
+82 (0)70 4419 6401
service@arri.kr
Business hours:
Mo. - Fr. 9:00 - 18:00 (KST)

CINEOM Broadcast India Pvt. Ltd.
C-4, Goldline Business Centre, Link Rd. Malad
West
400 064 Mumbai
India
+91 (0)22 42 10 9000
arrisupportindia@cincom.in
Business hours:
Mo. - Sa. 10:00 am - 06:00 pm (IST)

CINEOM Broadcast DMCC.
HDS Business Center, Unit No. 3503, Floor No. 35
Cluster M
Jumeirah Lake Towers
Dubai
Dubai, UAE
+971 (0) 45570477
arriservice.me@cincom.com
Business hours:
Sa. - Th. 9:00 am- 06:00 pm

LİNKA GÖRÜNTÜ IŞIK VE SES SİSTEMLERİ
TİCARET ANONİM ŞİRKETİ
Distributor & Service
Maslak Mah. AOS 55. Sokak 42 Maslak A Blok
SİTESİ
NO: 2 İÇ KAPI NO: 1
Sarıyer, İstanbul
Turkey
+90 2123584520
service@linkgroup.com.tr

ALEXA 35  XTREME